

STUDENT LIFE & ACADEMICS UNDER 5,000 SQ.FT.

DESIGNER: Jamie Boynton
EMAIL: jamieboynton@creighton.edu
PHONE NUMBER: 402-510-1966
SCHOOL: Creighton University

I HAVE RECEIVED PERMISSION FROM THE ARCHITECT FOR
USE OF PHOTOS OF THEIR WORK TO BE DISPLAYED ON THE
AUID WEBSITE: N/A – ARCHITECT WAS NOT INVOLVED

THIS PAGE WILL NOT BE SHARED WITH THE JUDGES, PLEASE
DO NOT INCLUDE ANY FLOOR PLANS OR PHOTOS ON THIS
PAGE.

IN ORDER TO PRESERVE ANONYMITY WITH THE JUDGES,
THE IDENTITY OF YOUR NAME/INSTITUTION SHOULD NOT BE
IN YOUR DESIGN INTENT STATEMENT OR IN PHOTOS (WHERE
POSSIBLE).

PLEASE EMAIL POWER POINT ENTRY DOCUMENT TO AUID
DESIGN COMPETITION EMAIL:

info@auid.org

STUDENT LIFE & ACADEMICS UNDER 5,000 SQ.FT.

PROJECT TITLE: Common Restrooms Remodel

SQUARE FOOTAGE: 274 SF

PROJECT BUDGET: \$50,000

DID YOU WORK WITH AN OUTSIDE FIRM OR CONSULTANT? IF YES, LIST COMPANY NAME: N

PROJECT DESCRIPTION:

Total project budget \$50,000 for men and women restroom remodels included demo of wall to floor tile and plumbing fixtures. Selection of all new finishes and materials: wall and floor tile, paint refresh, accessories, and plumbing fixtures. Additionally, a custom lavatory shield will be installed in both restrooms to protect residents from hot pipes to further ADA compliant restrooms.

This very outdated 80's themed restroom was the perfect opportunity to draw inspiration from a visit at Washtenaw Community College. They used large format and hexagon shaped tiles in a monochromatic color scheme for their common restrooms. Those tile shapes helped influenced my tile selections for this project remodel. I wanted to introduce a fun yet artistic accent and pair with a more clean-lined neutral tile for a modern and playful design. Also, considering an updated branded look using the university's color palette and balancing it by introducing a pop of soft blue.

BEFORE

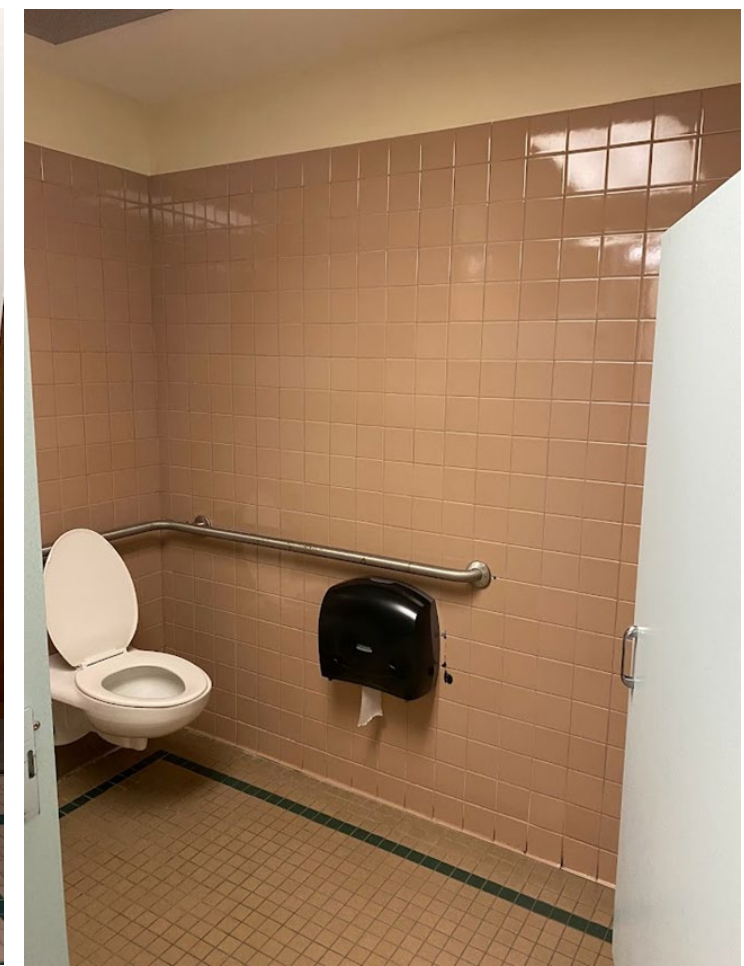

McGloin Dormitory Restrooms

AFTER



McGloin Dormitory Restrooms

PORTION OF PROJECT DESIGNER IS RESPONSIBLE FOR:

- FINISH SPECIFICATION
- WALL TREATMENT
- CEILING TREATMENT
- PROJECT COORDINATION AND REVIEW

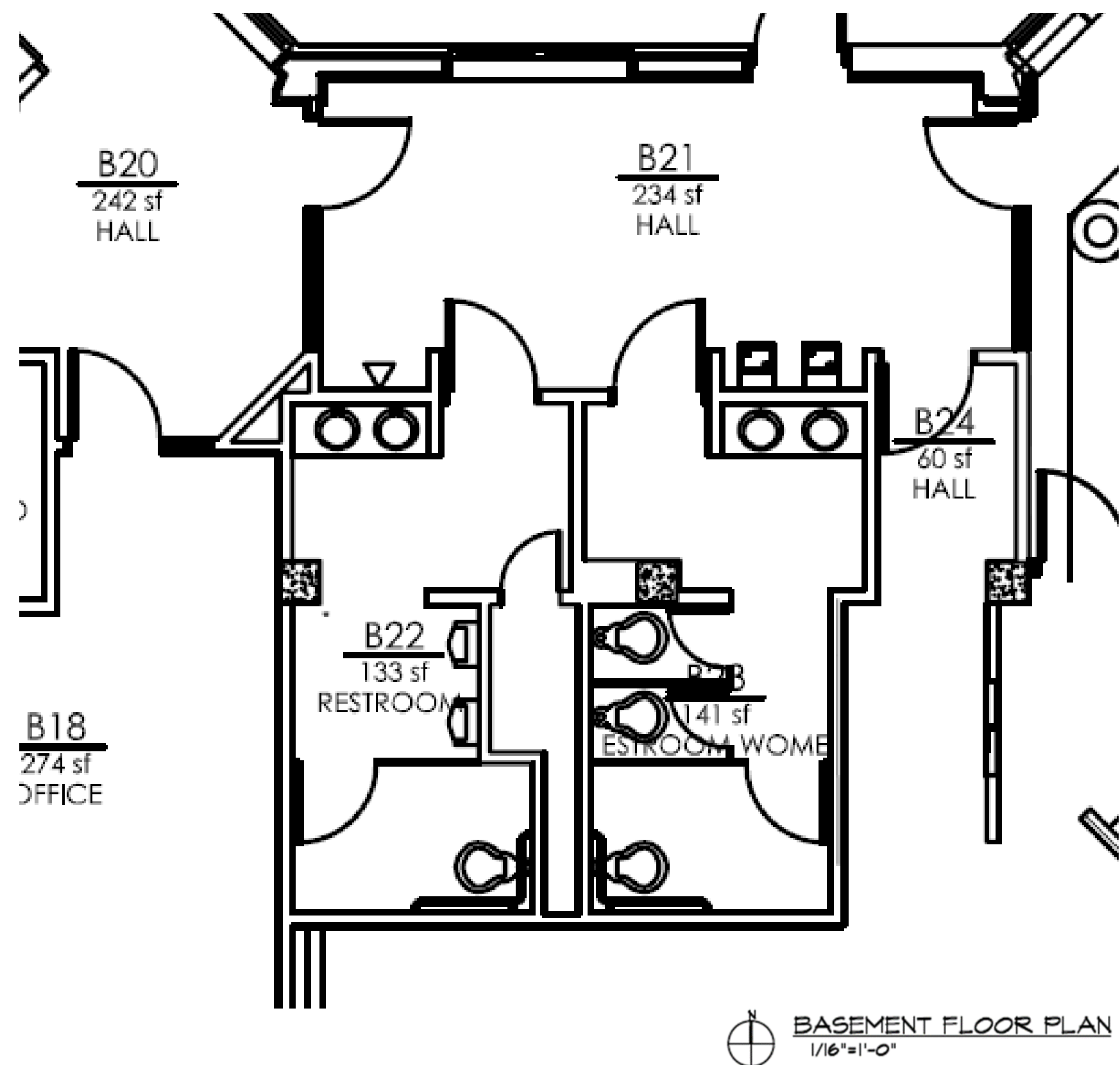

McGloin Dormitory Restrooms

ROOM	AREA	NO.
818	OFF. GYM	1407
815	ELECTRICAL ROOM	
814	JANITOR CLOSET	
802	RESTROOM MEN	
803	RESTROOM WOMEN	
814	ELEVATOR	
804	ELEVATOR	

3rd of 3 sheets

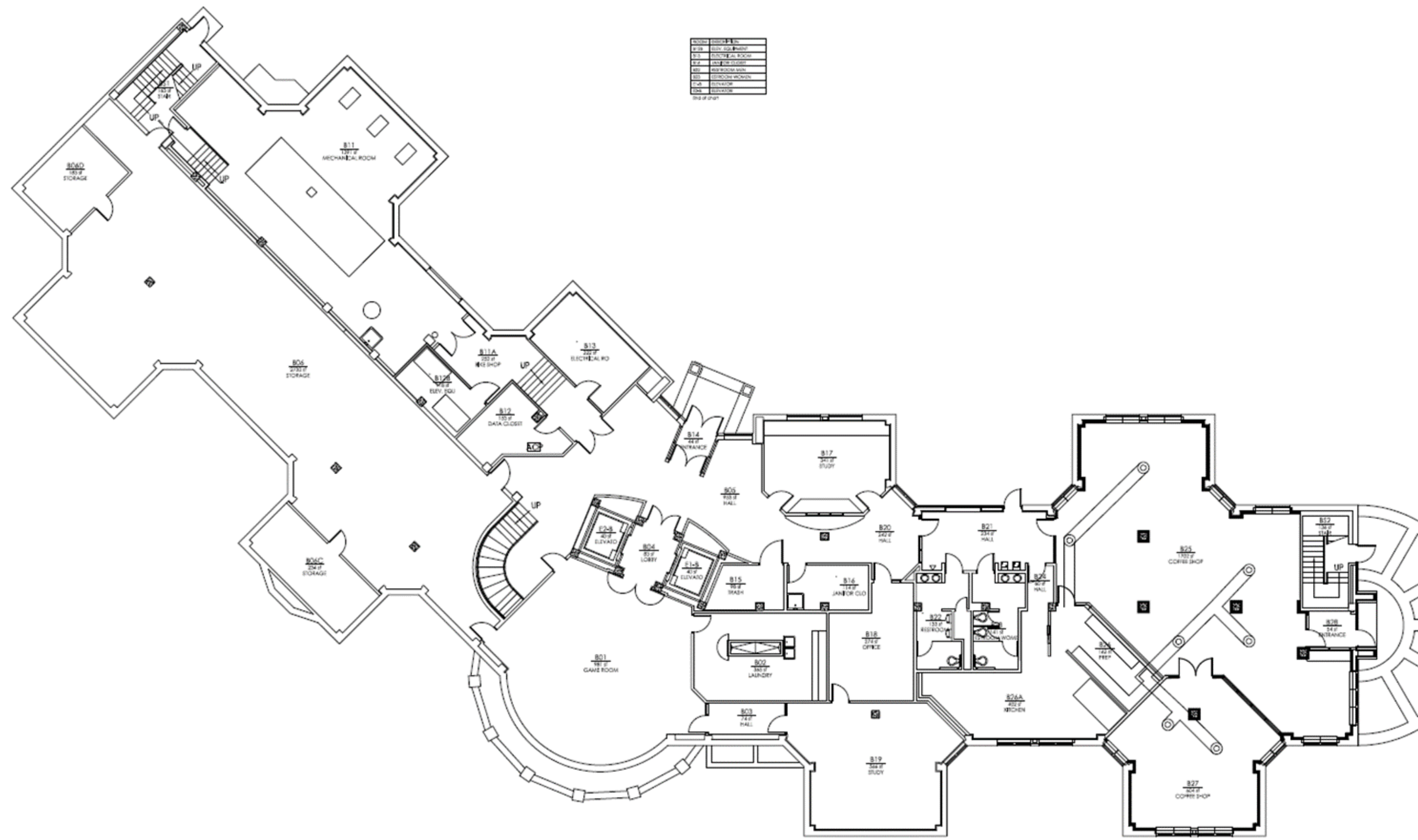

BASEMENT FLOOR PLAN
 1/16"=1'-0"

McGloin Dormitory Restrooms